

# VAL POWER<sup>®</sup>

## FLUID POWER EQUIPMENT

### VHP-10-25 / VHP-10-43 Manual Hand Pumps



Model: VHP-10-25



Model: VHP-10-43

#### FEATURES:

- TWO SPEED OPERATION
- RUGGED ALUMINUM CONSTRUCTION
- CONVENIENT CARRY HANDLE
- EASY FILL RESERVOIR CAP
- ERGOMETRIC HANDLE GRIP
- INTERNAL PRESSURE RELIEF VALVE

#### PERFORMANCE SPECIFICATIONS

| Pump Model             | VHP-10-25                      | VHP-10-43                      |
|------------------------|--------------------------------|--------------------------------|
| Reservoir Capacity     | 25 in <sup>3</sup> (410cc)     | 43 in <sup>3</sup> (705cc)     |
| Weight                 | 8 Lb (3.6 Kg)                  | 15 Lb (6.8 Kg)                 |
| Max Hydraulic Pressure | 10000 psi (680 bar)            | 10000 psi (680 bar)            |
| Low Pressure Flow      | .35 in <sup>3</sup> per stroke | .35 in <sup>3</sup> per stroke |
| High Pressure Flow     | .07 in <sup>3</sup> per stroke | .07 in <sup>3</sup> per stroke |
| Maximum Handle Effort  | 100 Lb (45 Kg)                 | 65 Lb (30 Kg)                  |

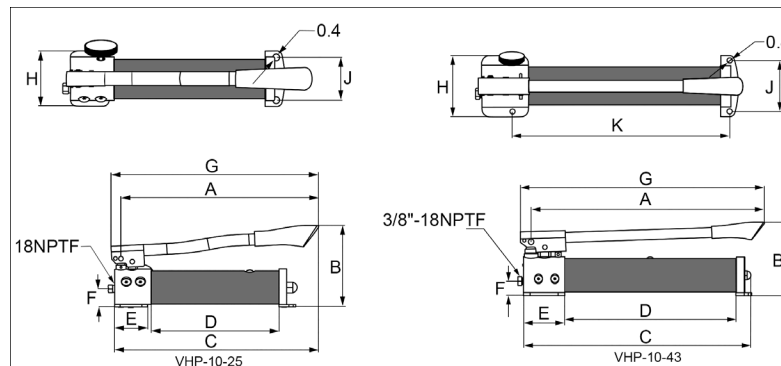

#### DIMENSION (in)

| Pump Model | A     | B    | C     | D     | E    | F    | G     | H    | J    | K     |
|------------|-------|------|-------|-------|------|------|-------|------|------|-------|
| VHP-10-25  | 13.43 | 5.91 | 13.89 | 9.09  | 2.36 | 1.34 | 14.13 | 3.35 | 2.56 | -     |
| VHP-10-43  | 21.77 | 6.34 | 23.03 | 14.96 | 3.59 | 1.26 | 19.96 | 4.88 | 3.94 | 16.93 |



Innovating SMART Hose Assembly Solutions Since 1979

Custom Crimp<sup>®</sup>

[www.customcrimp.com](http://www.customcrimp.com)

(219) 462-6128

